

# Manley Street

BERT DRIVE

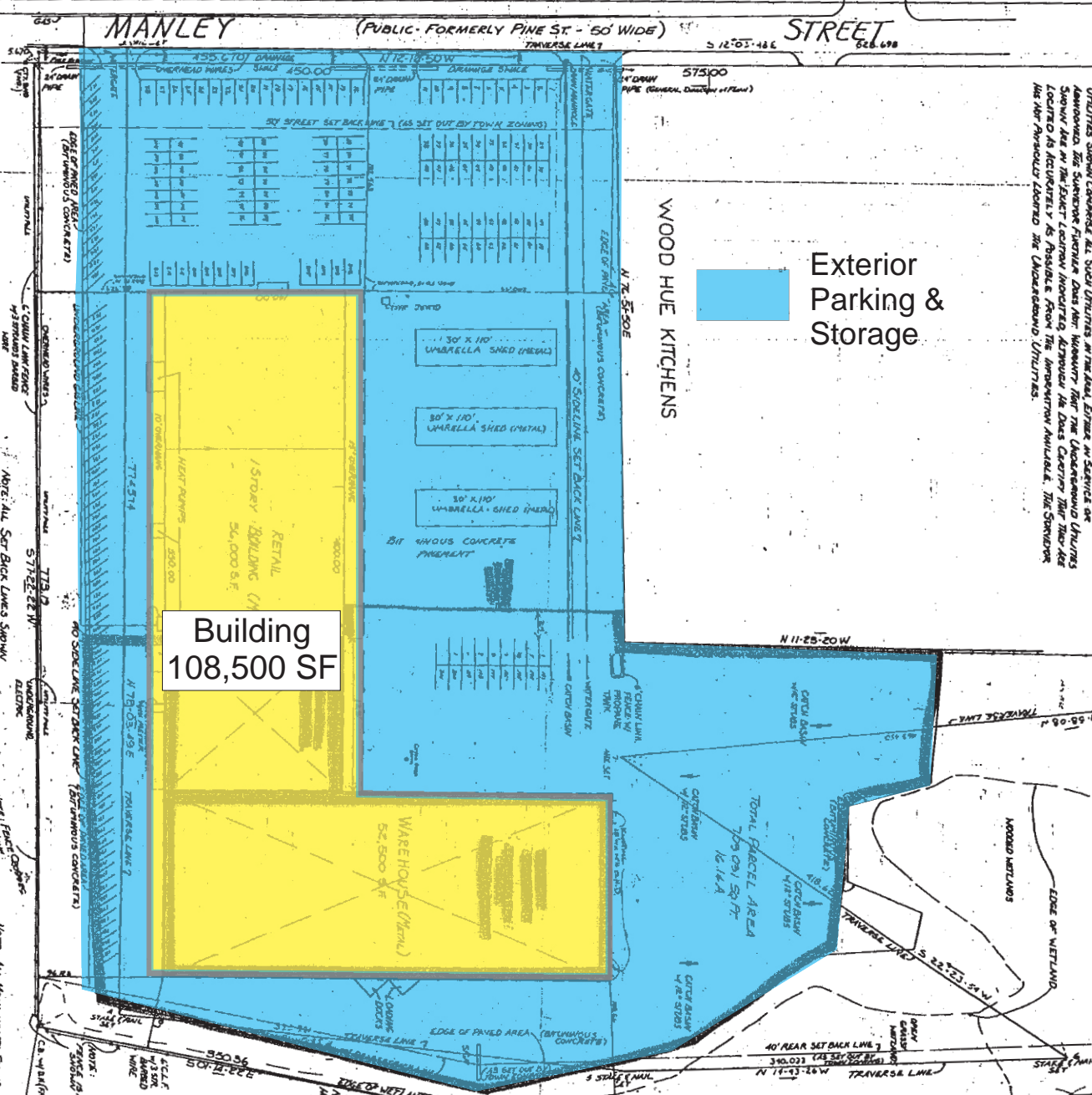

Exterior Parking & Storage

WOOD HUE KITCHENS

Building 108,500 SF

Rt. 24

HIGHWAY

AS BUILT PLAN OF LAND ON  
MANLEY STREET  
W. BRIDGEWATER, MASS.  
#175

DECEMBER 27, 1988  
REVISION: 1/7/89  
ENGINEER: SURVEYOR  
NEIL J. MURPHY  
100 OLD DERBY STREET  
HINGHAM, MASS. 02034

OWNER:  
SOMERVILLE LUMBER CO.  
779 RICHMOND HIGHWAY  
SOMERVILLE, MASS. 02153

SCALE: 1"=40'

LEGEND: CA = CONCRETE  
C = CURB  
S = SAND  
G = GRAVEL  
P = PAVEMENT  
L = LANDSCAPE  
T = TREE

333 MANLEY STREET  
W. BRIDGEWATER, MASS.

REGISTRATION NO.: 7140

DAVID H. SMITH  
Surveyor

I, HERBERT CERRY, THE ACCOUNTING SURVEYOR, HEREBY CERTIFY THAT THE ACCOMPANYING SURVEY CORRECTLY SHOWS THE LOCATION OF ALL BUILDINGS, STRUCTURES AND OTHER IMPROVEMENTS SHOWN ON THE ABOVE PLAN, AND THAT ALL EASEMENTS, CONVEYANCES AND RESTRICTIONS ARE REPRODUCED BY THIS TITLE INSURANCE COMPANY'S INSTRUMENT AS ASSIGNED BY ME TO THE ASSURED COMPANY. I HAVE CONDUCTED THE SURVEY AND RECONSTRUCTION OF THE BUILDING OR IMPROVEMENTS ON THE SUBJECT PROPERTY AS SHOWN ON THE ABOVE PLAN AND FOUND THAT THE SAME SHOWS THE LOCATION AND DIMENSIONS OF THE BUILDING OR IMPROVEMENTS AS SHOWN ON THE ABOVE PLAN AND FOUND THAT THE SAME SHOWS THE LOCATION AND DIMENSIONS OF THE BUILDING OR IMPROVEMENTS AS SHOWN ON THE ABOVE PLAN.

I, FURBER CERRY, THE SURVEYOR, DO HEREBY CERTIFY THAT THE ABOVE PLAN IS A TRUE AND CORRECT REPRESENTATION OF THE SURVEY AND RECONSTRUCTION OF THE BUILDING OR IMPROVEMENTS ON THE SUBJECT PROPERTY AS SHOWN ON THE ABOVE PLAN AND FOUND THAT THE SAME SHOWS THE LOCATION AND DIMENSIONS OF THE BUILDING OR IMPROVEMENTS AS SHOWN ON THE ABOVE PLAN.

DATE: THIS 27th DAY OF DECEMBER, 1988

NEIL J. MURPHY  
Surveyor

333 MANLEY STREET  
W. BRIDGEWATER, MASS.

STORE #175  
333 MANLEY ST.  
WEST BRIDGEWATER, MASS.